

rod seal S09-SD

seal spec

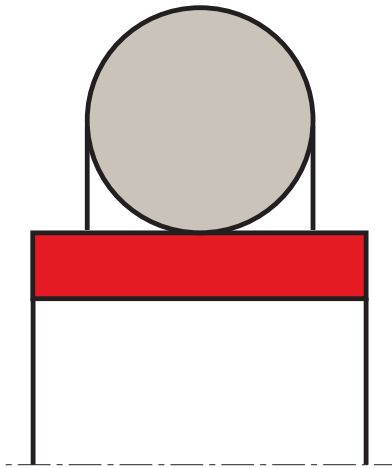

description

rod seal S09-SD consisting of profile ring and O-ring as a preload component.

application



category of profile

machined or molded/standard/trade product.

double acting

the S09-SD seal is designed for use as a piston seal.

area of application: hydraulics

advantages

rod seal for lower pressure range with properties of :

- low friction
- low housing height

operating parameters & material

material		temperature	max. surface speed	max. pressure ¹
sealing element	energizer			
s-mart PTFE bronze	s-mart NBR (70 shore A)	-30 °C ... +100 °C	2 m/s	160 bar (16 MPa)

the stated operation conditions represent general indications. it is recommended not to use all maximum values simultaneously. surface speed limits apply only to the presence of adequate lubrication film.

¹ pressure ratings are dependent on the size of the extrusion gap.

surface quality

surface roughness	Rtmax [µm]	Ra [µm]
sliding surface	≤2	≤0,05-0,3
bottom of groove	≤6,3	≤1,6
groove face	≤15	≤3

tolerance recommendation

seal housing tolerances	
Ød	f7
ØD	H9

gap dimension

the decisive factor for the function of the seal is the largest gap dimension occurring during operation on the non-pressurised side of the seal.

we recommend a metal guide H8/f7.



fitting & installation

careful fitting is a prerequisite for the correct function of the seal.

seal & housing recommendations

please note that we are able to produce those profiles to your specific need or any non standard housing. for detail measurements, please see seal-mart catalog...

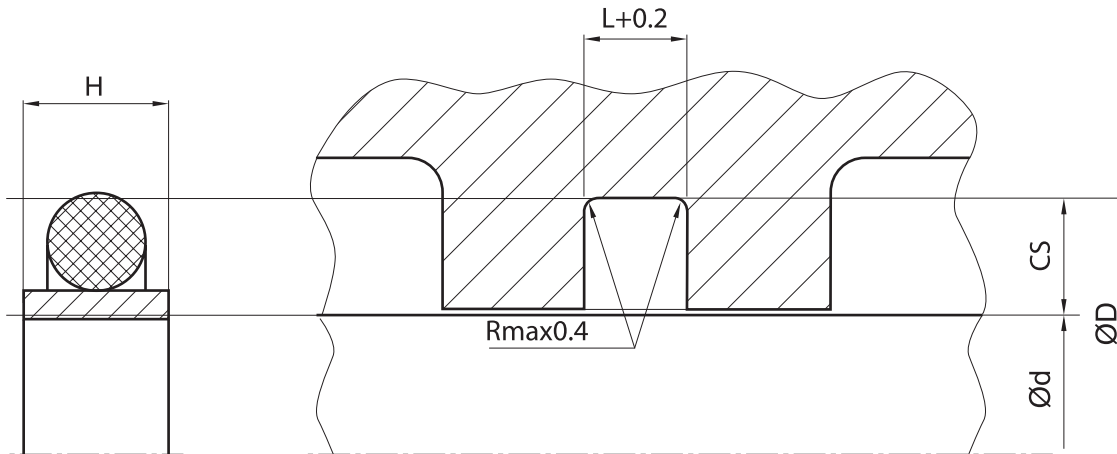

don't hesitate to contact our technical department for further information or for special requirements (temperature, speed etc.), so that suitable materials and/or designs can be recommended.